

## HISTORIC RESOURCES INVENTORY

Ser. No. 0213-022  
HABS \_\_\_\_\_ HAER \_\_\_\_\_ NR 4 SHL \_\_\_\_\_ Loc \_\_\_\_\_  
UTM: A 11-369800-3772900 B \_\_\_\_\_  
C \_\_\_\_\_ D \_\_\_\_\_

### IDENTIFICATION

1. Common name: None
2. Historic name: Getz, Milton Estate
3. Street or rural address: 1011 North Beverly Drive  
City Beverly Hills Zip 90210 County Los Angeles
4. Parcel number: 4348-001-023
5. Present Owner: \_\_\_\_\_ Address: \_\_\_\_\_  
City \_\_\_\_\_ Zip \_\_\_\_\_ Ownership is: Public \_\_\_\_\_ Private \_\_\_\_\_
6. Present Use: Residential Original use: Residential

### DESCRIPTION

- 7a. Architectural style: Spanish Colonial Revival
- 7b. Briefly describe the present *physical description* of the site or structure and describe any major alterations from its original condition:

Surrounded by gardens and grounds that remain lush and expansive despite partial subdivision of the original property in the 1960s, the Getz house is a two story Mediterranean estate. Its H-shaped plan accommodates a formal motor court on one side and terraced gardens and pools on the other. The house is clad in pink stucco and capped by tiled gable roofs. An elaborately articulated entry, framed by a hood, faces the fountain in the motor court. Above it, a loggia punctuated by columns is recessed. Ornate corbels support a balcony formed by a two bay arcade on another portion of the facade. Other notable features include an extensive use of pierced stucco screens, casement windows, iron balconies and grilles, and arcades. Alterations include a swimming pool which replaced a fountain, the addition of Moorish arcades and a cabana around the pool, and the glazing of an arcade on the garden elevation. Some of the original landscaping by Paul Thiene remains, although statuary has replaced the palm trees on either side of the linear reflecting pools.

Attach Photo(s) Here

Photograph not available.

8. Construction date: 1926  
Estimated \_\_\_\_\_ Factual X
9. Architect Kaufmann; Gordon B.
10. Builder Mayer; John
11. Approx. property size (in feet) irreg.  
Frontage 400 Depth 700  
or approx. acreage \_\_\_\_\_
12. Date(s) of enclosed photograph(s)  
1986

13. Condition: Excellent \_\_\_\_ Good X Fair \_\_\_\_ Deteriorated \_\_\_\_ No longer in existence \_\_\_\_
14. Alterations: \_\_\_\_\_
15. Surroundings: (Check more than one if necessary) Open land \_\_\_\_ Scattered buildings \_\_\_\_ Densely built-up XX  
Residential X Industrial \_\_\_\_ Commercial \_\_\_\_ Other: \_\_\_\_\_
16. Threats to site: None known X Private development \_\_\_\_ Zoning \_\_\_\_ Vandalism \_\_\_\_  
Public Works project \_\_\_\_ Other: \_\_\_\_\_
17. Is the structure: On its original site? X Moved? \_\_\_\_ Unknown? \_\_\_\_
18. Related features: \_\_\_\_\_

#### SIGNIFICANCE

19. Briefly state historical and/or architectural importance (include dates, events, and persons associated with the site.)

One of the most publicized estates in the City, the Milton Getz estate was designed in 1926 by architect Gordon Kaufmann. The consummate Mediterranean villa, the residence was extensively photographed for The Architectural Digest upon its completion. Photographs show elaborate use of terra cotta ornament, a motor court with fountain, the extensive use of colored tile, and an elaborate fireplace in the panelled library. Other rooms in the modified U-shaped plan included a ballroom, entrance hall, and loggia, and five bedroom suites. Getz, a businessman and banker, controlled the Union Bank and Trust Company of Los Angeles after his father-in-law and the bank's founder Kaspere Cohn retired. He was a member of the Los Angeles Athletic Club and other civic organizations. Getz' partner in the affairs of Union Bank and Trust was Ben R. Meyer. Both hired Gordon Kaufmann to design substantial estates for them, which in the turn led to Kaufmann and landscape architect Paul Thiene getting the commission to design the Doheny residence Greystone. Kaufmann was a prolific architect, designing in addition to the large residential commissions he had, buildings in (see continuation sheet)

20. Main theme of the historic resource: (If more than one is checked, number in order of importance.)  
Architecture I Arts & Leisure 2  
Economic/Industrial \_\_\_\_ Exploration/Settlement \_\_\_\_  
Government \_\_\_\_ Military \_\_\_\_  
Religion \_\_\_\_ Social/Education \_\_\_\_

21. Sources (List books, documents, surveys, personal interviews and their dates).

City of Beverly Hills building permits  
Regan, Michael. Stars, Moguls, Magnates.  
1966

Architectural Digest, VII:1. 1929

Architectural Digest, VII:2. 1929

22. Date form prepared November, 1986  
By (name) C. McAvoy & L. Heumann  
Organization City of Beverly Hills  
Address: 450 N. Crescent Dr.  
City Beverly Hills Zip 90210  
Phone: (213) 550-4881

Locational sketch map (draw and label site and surrounding streets, roads, and prominent landmarks):

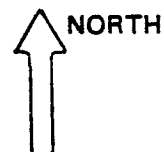

See continuation sheet

CONTINUATION SHEET: 1011 North Beverly Drive

19. Significance:

Westwood Village for the Janss Investment Company, the Los Angeles Times Building, and institutional buildings at CalTech and Scripps College. The home was later owned by actress Marion Davies and publisher William Randolph Hearst. The Getz estate is notable for its representation of an important architectural style in the area, and its association with a prominent architect and residents.

2195

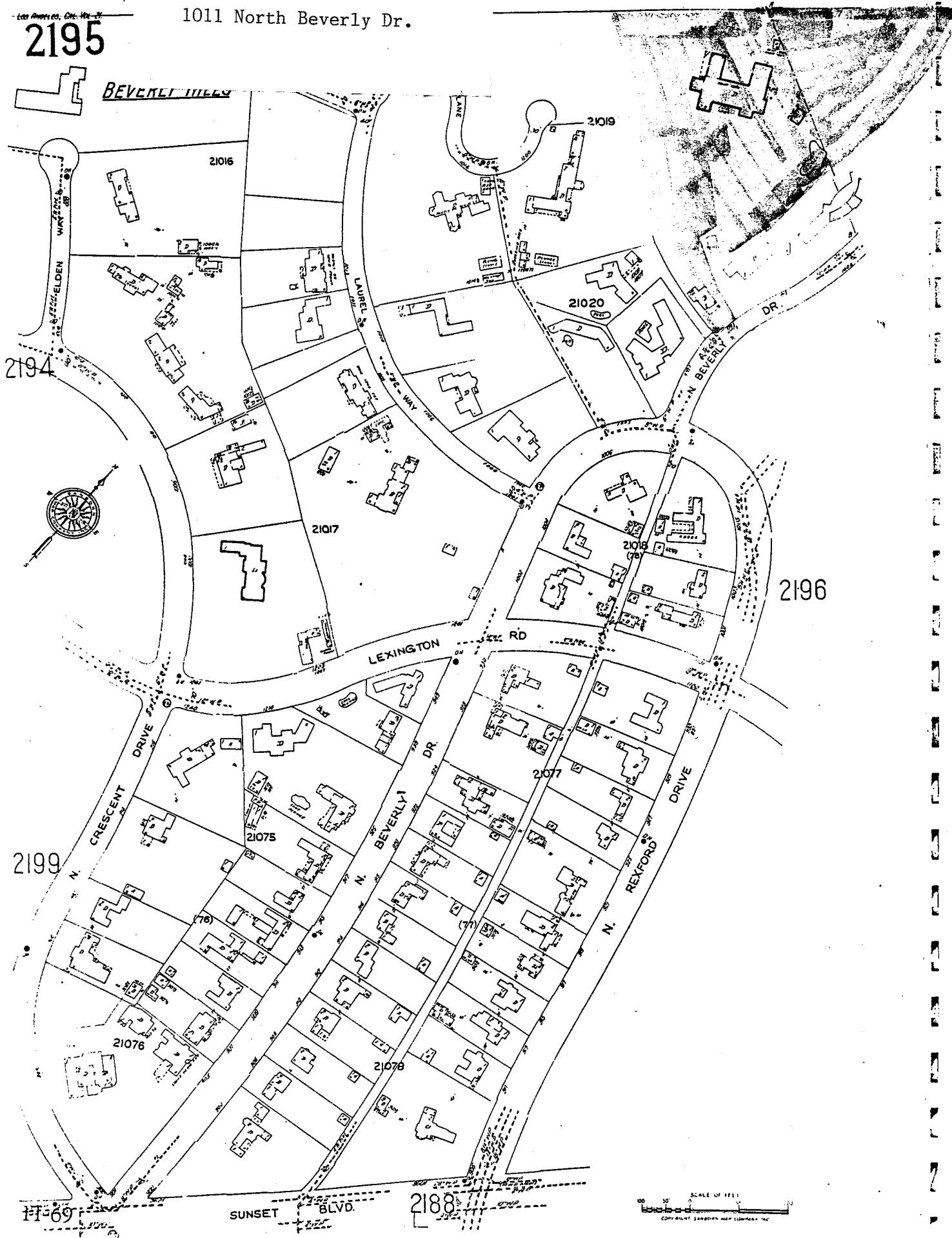

## CONTINUATION SHEET

Primary #

HRI #

Trinomial

NRHP Status Code: 7R

Page 1 of 1 Resource Name or # *Milton Getz Estate*

☐ Continuation ☒ Update

P2. Location: *1011 North Beverly Dr.*

**B10 Significance:**

*This property could not be properly re-evaluated because the building was not visible from the public right of way during the current survey process.*

**P5b Description/Date of Photo:**

No Photo Available

P8. Recorded by: *Jan Ostashay, Peter Moruzzi, PCR Services, One Venture, Suite 150, Irvine, CA 92618*

P9. Date Recorded: *Tuesday, June 01, 2004*