

HISTORIC RESOURCES INVENTORY

Ser. No. 0213-28
HABS _____ HAER _____ NR 3 SHL _____ Loc _____
UTM: A 11-368920-3972240 B _____
C _____ D _____

IDENTIFICATION

- 1. Common name: Beverly Hills Women's Club
- 2. Historic name: Beverly Hills Women's Club
- 3. Street or rural address: 1700 Chevy Chase Drive
City Beverly Hills Zip 90210 County Los Angeles
- 4. Parcel number: 4348-023-032
- 5. Present Owner: _____ Address: _____
City _____ Zip _____ Ownership is: Public _____ Private _____
- 6. Present Use: Institutional Original use: Institutional

DESCRIPTION

- 7a. Architectural style: Spanish Colonial Revival
- 7b. Briefly describe the present *physical description* of the site or structure and describe any major alterations from its original condition:

The Beverly Hills Women's Club is a one story building in the Spanish Colonial Revival style. Stucco-clad, the structure is capped by a tiled hip roof. The principal entry faces Chevy Chase Drive, and is framed in terra cotta or cast stone. Pilasters, scrolled brackets, and an entablature topped by a broken pediment with a shield and urn motif are incorporated into the door surround. Other notable features include casement windows, some ornamented with rejas, and a porte cochere on the Benedict Canon Drive elevation. Surrounded by trees and lawns, the clubhouse is integrated in design and scale with the surrounding neighborhood of single family homes.



- Construction date: 1925
Estimated _____ Factual X
- Architect Gable & Wyant
- Builder Unknown
- 1. Approx. property size (in feet)
Frontage 56 Depth 125
or approx. acreage _____
- 2. Date(s) of enclosed photograph(s)
1986

13. Condition: Excellent ___ Good ___ Fair ___ Deteriorated ___ No longer in existence ___
14. Alterations: _____
15. Surroundings: (Check more than one if necessary) Open land ___ Scattered buildings ___ Densely built-up
Residential Industrial ___ Commercial ___ Other: _____
16. Threats to site: None known Private development ___ Zoning ___ Vandalism ___
Public Works project ___ Other: _____
17. Is the structure: On its original site? Moved? ___ Unknown? ___
18. Related features: _____

SIGNIFICANCE

19. Briefly state historical and/or architectural importance (include dates, events, and persons associated with the site.)
 An historic meeting place for the community is the Beverly Hills Women's Club. The architectural firm of Gable and Wyant was commissioned to design the Club at the southwest corner of Benedict Canon and Chevy Chase in 1925. The team had designed several residences in the neighborhood, primarily in the Spanish Colonial Revival style, as well as commercial and institutional buildings throughout the Southland. Among their achievements are residences in Beverly Hills, Santa Monica and Hollywood, the several Los Angeles area schools (including Beverly Vista Elementary in Beverly Hills) and Hangar #1 at Los Angeles International Airport. The finely detailed Spanish building is the Club's first permanent home, members having met in private homes prior to its opening. Founded by 40 women of the City in 1916 for the dual purposes of fostering social contacts and promoting community service, the Women's Club joined the General Federation of Women's Clubs in 1924. Special "sections" enlarged the scope of activities to include dramatic readings, discussion of current events, a junior auxiliary, music, and French. The Club's philanthropic endeavors included a Red Cross unit during World War I, child welfare activities (including "securing worthwhile motion pictures for juvenile audiences"), and scholarships. The building continues to serve the Club today.

20. Main theme of the historic resource: (If more than one is checked, number in order of importance.)
 Architecture 1 Arts & Leisure _____
 Economic/Industrial ___ Exploration/Settlement ___
 Government ___ Military _____
 Religion ___ Social/Education 2
21. Sources (List books, documents, surveys, personal interviews and their dates).
 City of Beverly Hills building permits
22. Date form prepared November, 1986
 By (name) C. McAvoy & L. Heumann
 Organization City of Beverly Hills
 Address: 450 N. Crescent Dr.
 City Beverly Hills Zip 90210
 Phone: (213) 550-4881

Locational sketch map (draw and label site and surrounding streets, roads, and prominent landmarks):

↑ NORTH

See continuation sheet

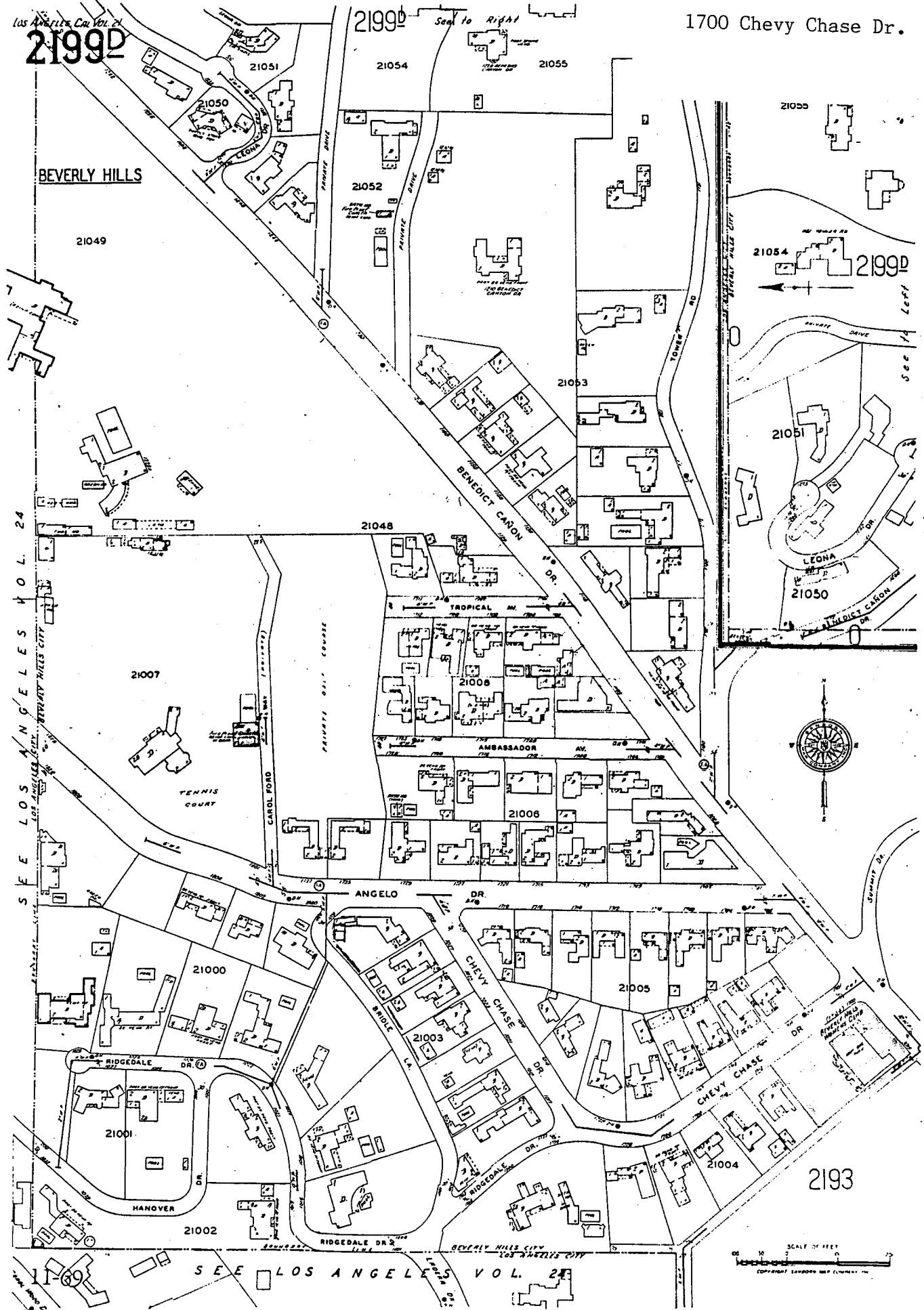

SEE LOS ANGELES VOL. 24

SEE LOS ANGELES VOL. 24

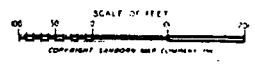

CONTINUATION SHEET

Primary #
HRI #
Trinomial
NRHP Status Code: 3S

Page 1 of 1 Resource Name or # *Beverly Hills Women's Club*

Continuation Update

P2. Location: *1700 Chevy Chase Dr.*

B10 Significance:

This building appears in good condition with no significant alterations visible since the property was last evaluated in the 1985-1986 survey. It remains eligible for listing in the National Register, California Register and for local listing or designation.

P5b Description/Date of Photo: *June, 2004*



P8. Recorded by: *Jan Ostashay, Peter Moruzzi, PCR Services, One Venture, Suite 150, Irvine, CA 92618*

P9. Date Recorded: *Tuesday, June 01, 2004*