



Environmental
Intelligence, LLC

October 13, 2023

Ms. Christine Chung
Associate Project Manager
Public Works Department
City of Beverly Hills
345 Foothill Road
Beverly Hills, CA 90210

Mr. Joseph DeMello
Director, Construction Manager
Westside Purple Line Extension Section 1
Los Angeles County Metropolitan Transportation Authority
One Gateway Plaza, 17th Floor
Los Angeles, CA 90012

Subject: Segment 1 - Purple Line Extension Project ICM Weekly Report
September 24, 2023 – September 30, 2023

Dear Ms. Chung and Mr. DeMello,

Environmental Intelligence, LLC (EI) has been retained by the City of Beverly Hills (COBH) and the Los Angeles County Metropolitan Transportation Authority (Metro) to serve as the independent compliance monitor (ICM) during construction of the Purple Line Extension Project. Monitoring is required to ensure construction is in compliance with the MOA for Contract C1045 of the Purple Line Extension Project – Segment 1 – Between the City of Beverly Hills and the Los Angeles County Metropolitan Transportation Authority (City Agreement No. 66-16). The following information summarizes the ICM monitoring activities that occurred at the Segment 1 site (La Cienega Station site) during the week of September 24, 2023 – September 30, 2023.

Construction activities during the week included: implementing and removing various lane closures throughout the site; placing concrete within the construction yards; preparing and placing concrete for the curb and gutter installation on Wilshire Blvd. between Tower Dr. and La Cienega Blvd.; transitional grinding and pavement recycling on Wilshire Blvd. between Tower Dr. and La Cienega Blvd.; hauling out grindings from the closures on Wilshire Blvd.; hauling out concrete debris from the N. Gale yard; placing slurry in the k-rail closures between S. Gale Dr. and La Cienega Blvd.; installing station and utility support materials within the station and appendages; receiving various construction materials deliveries to the site; hoisting materials and equipment into and out of the tunnel from the La Cienega and Gale yards; transporting machinery and materials throughout the site; and cleaning and maintaining the site. EI ICMs were present on site during all construction activities. ICMs conducted routine noise measurements at selected noise monitoring locations as well as compliance checks in accordance with the MOAs and associated attachments, exhibits, traffic closure notifications, and traffic management plans. At the conclusion of each work shift, daily monitoring reports were prepared by the respective ICM. Any violations for that date were also prepared by the ICM then reviewed and submitted to the COBH and Metro by EI's Project Manager.

VIOLATION SUMMARY

During the week, EI ICMs identified no violations during construction activities. Daily monitoring reports and photographs of construction activities are provided as Attachment A (*Daily Monitoring Reports*). Daily noise monitoring data are provided in Attachment B (*Noise Monitoring Data Log*).

Christine Chung
Joseph DeMello
October 13, 2023

CONCLUSION

To date, 360 violations have been issued, 30 of which have been rescinded since the beginning of construction on the C1045 Contract for the Purple Line Extension Project – Segment 1. Project construction activities are ongoing and EI ICMs continue to monitor all construction activities applicable to the MOAs on a daily basis.

If you have any questions or comments regarding this letter, please contact me directly at 310.469.8989 or jeremiahgeorge@enviro-intel.com.

Sincerely,

ENVIRONMENTAL INTELLIGENCE, LLC

A handwritten signature in black ink, appearing to read "Jeremiah George", enclosed within a large, loopy oval flourish.

Jeremiah George
Project Manager

Attachments: Attachment A: Daily Monitoring Reports
Attachment B: Noise Monitoring Data Log

cc: Nell Mardirosian, Los Angeles County Metropolitan Transportation Authority
Candace Lee, Los Angeles County Metropolitan Transportation Authority
William Hamilton, City of Beverly Hills
Kanna Vancheswaran, Psomas
Brett Barnett, Psomas



Attachment A
Daily Monitoring Report
 9/24/2023 - 9/30/2023



Summaries (7)

Date Tuesday, September 26, 2023
Monitor Annamarie Hand
Location La Cienega Station
Time 04:45:00 to 15:15:00
Compliant Yes
Summary Contractors/Subcontractors: STS; Century Sweeping; Dynalectric; JNA; PSG/ Marvella; UMEC; LKC; Rascom; Link Nilsen/ EMF; Global Electric; DPSI; ECA; Cemex.
 Representatives: German Garcia (Metro); Thomas Wukadinovich (STS); Walter Sanchez (STS); Adnan Aldwir (Psomas).
 Work Location(s): N. Gale yard closure; N. Gale yard; La Cienega yard; Below the deck on Wilshire Blvd.; Wilshire Blvd. EB/ WB 1 K-Rail closure.; Wilshire Blvd. EB 2.; S. Hamilton full closure at Wilshire Blvd.
 The ICM was in possession of applicable COBH-approved closure notifications and TCP for the day's work from 04:45 to 15:15 hours September 26th, 2023. EI ICM Annamarie Hand met with Thomas Wukadinovich (STS) to discuss the shift's activities. At the beginning of the shift, the ICM calibrated the noise meter at 94.00 dB.
 Work for the shift included: Concrete placement in the La Cienega yard; Prepping the curb and gutter; Installation of HDPE, plumbing, fire water pipes, rebar, conduit, ducts, and CMU; Deliveries of miscellaneous materials; Hoisting machinery, debris, materials and equipment in/out of the station in the N. Gale and La Cienega yards; Transportation of machinery and materials in the N. Gale yard, N. Gale yard closure, and k-rail closures; Work within the station, excavated appendages, and in k-rail closures; General cleaning and clearing of debris from the appendage, closures, yards, and within the station.
 Note: Non-project related construction on S. Gale Dr. at Wilshire Blvd.

Date Tuesday, September 26, 2023
Monitor Dylan McGovern
Location La Cienega Station
Time 14:30:00 to 00:00:00
Compliant Yes
Summary Contractors/Subcontractors: STS; Psomas; Metro.
 Representatives On-Site: N/A.
 Work Location(s): Wilshire Blvd. between Gale Dr. and La Cienega Blvd.
 The ICM was in possession of applicable COBH-approved closure notifications and TCP for the day's work from 14:30 hours on September 26th, 2023 to 00:00 hours on September 27th, 2023. EI ICM Dylan McGovern met with STS crews to discuss the day's activities. At the beginning of the shift, the ICM calibrated the noise meter to 94.00 dB.
 Work for the day included: STS working underground in station below Gale yard and underground in station below La Cienega yard. Note: Ventilation system was audible in La Cienega yard and noise reading was recorded on N. Hamilton Dr. as under threshold.





Attachment A
Daily Monitoring Report
 9/24/2023 - 9/30/2023



Date Wednesday, September 27, 2023
Monitor Annamarie Hand
Location La Cienega Station
Time 04:45:00 to 15:15:00
Compliant Yes
Summary Contractors/Subcontractors: STS; Century Sweeping; Dynalectric; JNA; PSG/ Marvella; UMEC; LKC; Rascom; Link Nilsen/ EMF; Global Electric; DPSI; ECA; Cemex.
 Representatives: German Garcia (Metro); Thomas Wukadinovich (STS); Walter Sanchez (STS); Charlie Briceno (Psomas).
 Work Location(s): N. Gale yard closure; N. Gale yard; La Cienega yard; Below the deck on Wilshire Blvd.; Wilshire Blvd. EB/ WB 1 K-Rail closure.
 The ICM was in possession of applicable COBH-approved closure notifications and TCP for the day's work from 04:45 to 15:15 hours September 27th, 2023. EI ICM Annamarie Hand met with Thomas Wukadinovich (STS) to discuss the shift's activities. At the beginning of the shift, the ICM calibrated the noise meter at 94.00 dB.
 Work for the shift included: Concrete placement in the La Cienega yard; Prepping the curb and gutter; Installation of HDPE, plumbing, fire water pipes, rebar, conduit, ducts, and CMU; Deliveries of miscellaneous materials; Hoisting machinery, debris, materials and equipment in/out of the station in the N. Gale and La Cienega yards; Transportation of machinery and materials in the N. Gale yard, N. Gale yard closure, and k-rail closures; Work within the station, excavated appendages, and in k-rail closures; General cleaning and clearing of debris from the appendage, closures, yards, and within the station.
 Note: Non-project related construction on S. Gale Dr. at Wilshire Blvd.

Date Wednesday, September 27, 2023
Monitor Dylan McGovern
Location La Cienega Station
Time 14:30:00 to 00:00:00
Compliant Yes
Summary Contractors/Subcontractors: STS; Psomas; Metro.
 Representatives On-Site: N/A.
 Work Location(s): Wilshire Blvd. between Gale Dr. and La Cienega Blvd.
 The ICM was in possession of applicable COBH-approved closure notifications and TCP for the day's work from 14:30 hours on September 27th, 2023 to 00:00 hours on September 28th, 2023. EI ICM Dylan McGovern met with STS crews to discuss the day's activities. At the beginning of the shift, the ICM calibrated the noise meter to 94.00 dB.
 Work for the day included: STS working underground in station below Gale yard; STS utilizing crane in Gale yard to move construction materials from the station to the yard.
 Note: Ventilation system was audible in La Cienega yard and noise reading was recorded on N. Hamilton Dr. as under threshold.





Attachment A

Daily Monitoring Report

9/24/2023 - 9/30/2023



Date Thursday, September 28, 2023

Monitor Annamarie Hand

Location La Cienega Station

Time 04:45:00 to 15:15:00

Compliant Yes

Summary Contractors/Subcontractors: STS; Century Sweeping; Dynalectric; JNA; PSG/ Marvella; UMEC; LKC; Rascom; Link Nilsen/ EMF; Global Electric; DPSI; ECA; Cemex; Railworks.

Representatives: German Garcia (Metro); Thomas Wukadinovich (STS); Walter Sanchez (STS); Gene Higginbotham (Psomas).

Work Location(s): N. Gale yard closure; N. Gale yard; La Cienega yard; Below the deck on Wilshire Blvd.; Wilshire Blvd. EB/ WB 1 K-Rail closure.

The ICM was in possession of applicable COBH-approved closure notifications and TCP for the day's work from 04:45 to 15:15 hours September 28th, 2023. EI ICM Annamarie Hand met with Thomas Wukadinovich (STS) to discuss the shift's activities. At the beginning of the shift, the ICM calibrated the noise meter at 94.00 dB.

Work for the shift included: Panel removal and spot welding access hatches on the North Wilshire Blvd. sidewalk; Concrete placement for the curb and gutter on Wilshire Blvd. from Tower Dr. to La Cienega Blvd; Forming the curb and gutter from Tower Dr. to La Cienega Blvd; Installation of HDPE, plumbing, fire water pipes, rebar, conduit, ducts, and CMU; Deliveries of miscellaneous materials; Hoisting machinery, debris, materials and equipment in/out of the station in the N. Gale and La Cienega yards; Transportation of machinery and materials in the N. Gale yard, N. Gale yard closure, and k-rail closures; Work within the station, excavated appendages, and in k-rail closures; General cleaning and clearing of debris from the appendage, closures, yards, and within the station.

Note: Non-project related construction on S. Gale Dr. at Wilshire Blvd.

Date Friday, September 29, 2023

Monitor Annamarie Hand

Location La Cienega Station

Time 04:45:00 to 15:15:00

Compliant Yes

Summary Contractors/Subcontractors: STS; Century Sweeping; Dynalectric; JNA; PSG/ Marvella; UMEC; LKC; Rascom; Link Nilsen/ EMF; Global Electric; DPSI; ECA; Cemex; Railworks; National Concrete Washout; Pavement Recycling Systems.

Representatives: German Garcia (Metro); Thomas Wukadinovich (STS); Walter Sanchez (STS); Charlie Briceno (Psomas).

Work Location(s): N. Gale yard closure; N. Gale yard; La Cienega yard; Below the deck on Wilshire Blvd.; Wilshire Blvd. EB/ WB 1 K-Rail closure.; Wilshire Blvd. EB 2 La Cienega Blvd. to Tower Dr.; Hamilton Dr. full closure at Wilshire Blvd.

The ICM was in possession of applicable COBH-approved closure notifications and TCP for the day's work from 04:45 to 15:15 hours September 29th, 2023. EI ICM Annamarie Hand met with Thomas Wukadinovich (STS) to discuss the shift's activities. At the beginning of the shift, the ICM calibrated the noise meter at 94.00 dB.

Work for the shift included: Transitional grinding and pavement recycling on Wilshire Blvd. between Tower Dr. and La Cienega Blvd.; Hauling out grindings from the closures on Wilshire Blvd.; Hauling out concrete debris from the N. Gale yard; Concrete placement in the N. Gale yard; Slurry placement in the k-rail closures between S. Gale Dr. and La Cienega Blvd; Installation of HDPE, seismic angles, conduit, ducts, and CMU; Deliveries of miscellaneous materials; Hoisting machinery, debris, materials and equipment in/out of the station in the N. Gale and La Cienega yards; Transportation of machinery and materials in the N. Gale yard, N. Gale yard closure, and k-rail closures; Work within the station, excavated appendages, and in k-rail closures; General cleaning and clearing of debris from the appendage, closures, yards, and within the station.

Note: Non-project related construction on S. Gale Dr. at Wilshire Blvd.





Attachment A
Daily Monitoring Report
9/24/2023 - 9/30/2023



Date Saturday, September 30, 2023
Monitor Annamarie Hand
Location La Cienega Station
Time 04:45:00 to 13:15:00
Compliant Yes
Summary Contractors/Subcontractors: STS; Century Sweeping; Rascom; ECA; Railworks.
Representatives: German Garcia (Metro); Thomas Wukadinovich (STS).
Work Location(s): N. Gale yard closure; N. Gale yard; La Cienega yard; Below the deck on Wilshire Blvd.; Wilshire Blvd. EB/ WB 1 K-Rail closure.
The ICM was in possession of applicable COBH-approved closure notifications and TCP for the day's work from 04:45 to 13:15 hours September 30th, 2023. EI ICM Annamarie Hand met with Thomas Wukadinovich (STS) to discuss the shift's activities. At the beginning of the shift, the ICM calibrated the noise meter at 94.00 dB.
Work for the shift included: Stripping exterior face of walls for Appendage AB/AC; Installation of HDPE; Hoisting machinery, debris, materials and equipment in/out of the station in the N. Gale and La Cienega yards; Transportation of machinery and materials in the N. Gale yard, N. Gale yard closure, and k-rail closures; Work within the station, excavated appendages, and in k-rail closures; General cleaning and clearing of debris from the appendage, closures, yards, and within the station.





Photos



Photos (31)

UID: 11047 **Latitude:** 34.065765
Date: Sep 26, 2023 **Longitude:** -118.376117
Type: Construction Activity **Elevation:** ---

Notes
 Photo shows La Cienega yard where STS crews are working underneath in the station.

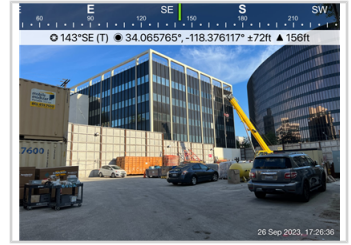

UID: 11046 **Latitude:** 34.06527
Date: Sep 26, 2023 **Longitude:** -118.374367
Type: Construction Activity **Elevation:** ---

Notes
 Photo shows Gale yard where STS is staging crane and deck panels.



UID: 11045 **Latitude:** 34.065033
Date: Sep 26, 2023 **Longitude:** -118.374478
Type: Construction Activity **Elevation:** ---

Notes
 Photo shows underground area where STS is working below Gale yard.



UID: 11036 **Latitude:** 34.064774
Date: Sep 26, 2023 **Longitude:** -118.375142
Type: Construction Activity **Elevation:** ---

Notes
 Photo shows duct work in the SCE vault in the STS closure on S. Hamilton Dr. at Wilshire Blvd.



UID: 11038 **Latitude:** 34.064608
Date: Sep 26, 2023 **Longitude:** -118.374225
Type: Construction Activity **Elevation:** ---

Notes
 Photo shows STS working in the excavated appendage in the k-rail closure on Wilshire Blvd. at S. Gale Dr.





Photos



UID: 11039
Date: Sep 26, 2023
Type: Construction Activity

Latitude: 34.064543
Longitude: -118.373895
Elevation: ---

Notes
Photo shows STS prepping the curb and gutter for future concrete placement on Wilshire Blvd. between Tower Dr. and Hamilton Dr.



UID: 11037
Date: Sep 26, 2023
Type: Construction Activity

Latitude: 34.06487
Longitude: -118.375229
Elevation: ---

Notes
Photo shows STS working in the k-rail closure on Wilshire Blvd. between Hamilton Dr. and La Cienega Blvd.



UID: 11034
Date: Sep 26, 2023
Type: Construction Activity

Latitude: 34.065247
Longitude: -118.375792
Elevation: ---

Notes
Photo shows Cemex placing concrete in the STS La Cienega yard.



UID: 11035
Date: Sep 26, 2023
Type: Construction Activity

Latitude: 34.065725
Longitude: -118.376011
Elevation: ---

Notes
Photo shows Cemex placing concrete in the STS La Cienega yard.



UID: 11043
Date: Sep 27, 2023
Type: Construction Activity

Latitude: 34.064713
Longitude: -118.374577
Elevation: ---

Notes
Photo shows Cemex placing concrete through the excavated appendage in the STS k-rail closure on Wilshire Blvd. at S. Gale Dr.



UID: 11040
Date: Sep 27, 2023
Type: Construction Activity

Latitude: 34.064934
Longitude: -118.37456
Elevation: ---

Notes
Photo shows Cemex placing concrete in the STS N. Gale yard.





Photos



UID: 11041
Date: Sep 27, 2023
Type: Construction Activity

Latitude: 34.065323
Longitude: -118.374211
Elevation: ---

Notes

Photo shows Cemex placing concrete in the STS N. Gale yard.



UID: 11044
Date: Sep 27, 2023
Type: Construction Activity

Latitude: 34.06487
Longitude: -118.375239
Elevation: ---

Notes

Photo shows STS placing structural backfill for the curb and gutter on Wilshire Blvd. between S. Hamilton Dr. and La Cienega Blvd.



UID: 11042
Date: Sep 27, 2023
Type: Construction Activity

Latitude: 34.064618
Longitude: -118.37421
Elevation: ---

Notes

Photo shows Cemex placing concrete through the excavated appendage in the STS k-rail closure on Wilshire Blvd. at S. Gale Dr.



UID: 11050
Date: Sep 27, 2023
Type: Construction Activity

Latitude: 34.065325
Longitude: -118.374302
Elevation: ---

Notes

Photo shows STS staging skidsteer and forklift inside Gale yard.



UID: 11048
Date: Sep 27, 2023
Type: Construction Activity

Latitude: 34.065645
Longitude: -118.375838
Elevation: ---

Notes

Photo shows underground area below La Cienega yard where STS crews are working.



UID: 11049
Date: Sep 27, 2023
Type: Construction Activity

Latitude: 34.064972
Longitude: -118.374522
Elevation: ---

Notes

Photo shows underground area below Gale yard where STS crews are working.

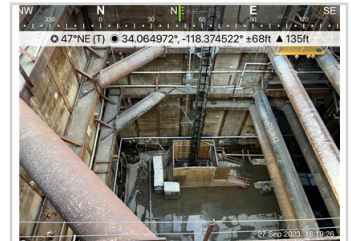



Photos



UID: 11061
Date: Sep 30, 2023
Type: Construction Activity

Latitude: 34.065305
Longitude: -118.374262
Elevation: ---

Notes

Photo shows STS unloading debris lifted out from the tunnel in the N. Gale yard.



UID: 11064
Date: Sep 30, 2023
Type: Construction Activity

Latitude: 34.065051
Longitude: -118.375986
Elevation: ---

Notes

Photo shows STS working in the excavated appendage and k-rail closure on Wilshire Blvd. between Hamilton Dr. and La Cienega Blvd.





Attachment B – Construction Noise Monitoring Results

Receptor ID	Time of Measurement	Measured Noise Level Leq (15-Minute)	Applicable Noise Threshold	Exceeded Threshold?	Notes
September 26, 2023					
SLC-2	17:34	59.8	72.4	No	STS crews working in the station underground below Gale yard.
SLC-7	17:51	63.7	72.4	No	STS crews working in the station underground below Gale yard.
SLC-1	18:12	56.8	65.5	No	STS crews working in the station underground below Gale yard as well as below La Cienega yard; Note: Ventilation system was audible in La Cienega yard and noise reading was recorded on N. Hamilton Dr. as under threshold.
September 27, 2023					
SLC-7	18:34	60.6	70	No	STS crews working in the station underground below Gale yard.
SLC-2	18:55	58.3	70	No	STS crews working in the station underground below Gale yard.
SLC-1	19:17	54.5	67.2	No	STS crews working in the station underground below Gale yard as well as below La Cienega yard; Note: Ventilation system was audible in La Cienega yard and noise reading was recorded on N. Hamilton Dr. as under threshold.