

HISTORIC RESOURCES INVENTORY

IDENTIFICATION

1. Common name: None
2. Historic name: Foote; William D. Residence
3. Street or rural address: 905 North Camden Drive
City Beverly Hills Zip 90210 County Los Angeles
4. Parcel number: 4345-004-009
5. Present Owner: _____ Address: _____
City _____ Zip _____ Ownership is: Public _____ Private _____
6. Present Use: Residential Original use: Residential

DESCRIPTION

- 7a. Architectural style: Mediterranean
- 7b. Briefly describe the present *physical description* of the site or structure and describe any major alterations from its original condition:

This elegant Mediterranean style home is located at the intersection of Camden Drive and Benedict Canon Drive. Its most prominent feature is its architectural detailing, executed in terra cotta or stone. Particularly notable are the arched entry, framed by decorated pilasters, reveals, keystone, and intrados; intricately patterned corbels and a balcony over the entrance; an equally ornamented balcony supported by a tapered corbel at the south end of the facade; and the shutter-like panels and keystones which adorn other openings. The detailing contrasts with the white stucco walls, banded between stories by stringcourses, and tiled hip roof of the two story structure. Paired brackets ornament the eaves. Windows are casement in type and include three arched openings south of the entry and a flat-headed opening with an iron grille north of it. Several pierced stucco grilles also screen openings. Set back from Camden by a circular drive, the house is shaded by a large tree in the lawn next to the driveway.



9. Construction date: 1915
Estimated _____ Factual X
10. Architect Unknown
11. Builder Unknown
12. Approx. property size (in feet) irreg.
Frontage 103 Depth 230
or approx. acreage _____
13. Date(s) of enclosed photograph(s)
1986

13. Condition: Excellent ___ Good Fair ___ Deteriorated ___ No longer in existence ___
14. Alterations: _____
15. Surroundings: (Check more than one if necessary) Open land ___ Scattered buildings ___ Densely built-up
Residential Industrial ___ Commercial ___ Other: _____
16. Threats to site: None known Private development ___ Zoning ___ Vandalism ___
Public Works project ___ Other: _____
17. Is the structure: On its original site? ___ Moved? ___ Unknown? ___
18. Related features: _____

SIGNIFICANCE

19. Briefly state historical and/or architectural importance (include dates, events, and persons associated with the site.)

Like its neighbor to the south, the property at 905 North Camden Drive was first purchased from the Rodeo Land and Water Company by H. Foote in 1914. In 1915 a substantial structure was erected on the site. In 1917 ownership passed to William Foote, who had built the residence at 901 the year before. The two homes are the only residences on the short block of Camden on the west side. In 1929, owner Charles Karsh hired local architect and builder Rene Rivierre to complete over \$10,000 worth of unspecified alterations to the residence. Rivierre was the designer of several other Spanish Colonial Revival residences in the area, including one at 705 North Arden Drive Drive. Featured on a recent home tour, the residence is significant for its exemplary type of Mediterranean revival design within the City, and for its contribution to the streetscape on North Camden Drive.

20. Main theme of the historic resource: (If more than one is checked, number in order of importance.)
Architecture Arts & Leisure _____
Economic/Industrial ___ Exploration/Settlement _____
Government ___ Military _____
Religion ___ Social/Education _____

21. Sources (List books, documents, surveys, personal interviews and their dates).

City of Beverly Hills building permits
Los Angeles County Tax Assessor records

22. Date form prepared November, 1986
By (name) C. McAvoy & L. Heumann
Organization City of Beverly Hills
Address: 450 N. Crescent Dr.
City Beverly Hills Zip 90210
Phone: (213) 550-4881

Locational sketch map (draw and label site and surrounding streets, roads, and prominent landmarks):

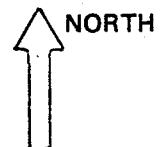

See continuation sheet

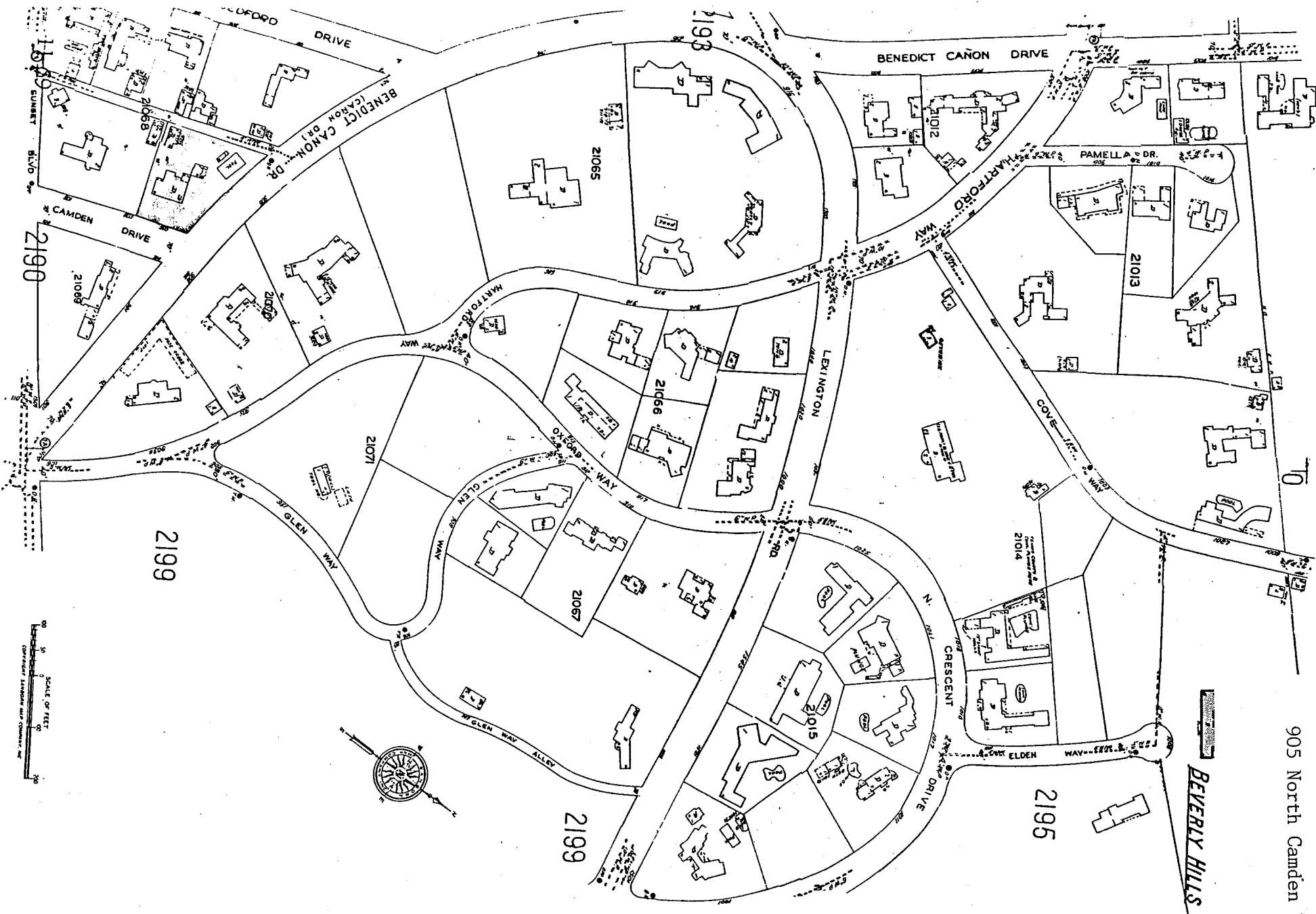

905 North Camden Dr.

BEVERLY HILLS

CONTINUATION SHEET

Primary #
HRI #
Trinomial
NRHP Status Code: 5S3

Page 1 of 1 Resource Name or # *William D. Foote Residence*

Continuation Update

P2. Location: *905 North Camden Dr.*

B10 Significance:

This building appears in good condition with no significant alterations visible since the property was last evaluated in the 1985-1986 survey. It remains eligible for local listing or designation.

P5b Description/Date of Photo: *East elevation, looking west/May 2004*



P8. Recorded by: *Jan Ostashay, Peter Moruzzi, PCR Services, One Venture, Suite 150, Irvine, CA 92618*

P9. Date Recorded: *Tuesday, June 01, 2004*